

Schedule

Application Deadline (Envelope must be postmarked by this date)	June 30, 2006
Announcement of Finalists	August 25, 2006
Proposals Due from Finalists	Fall 2006
Commission Announcements	Winter 2006

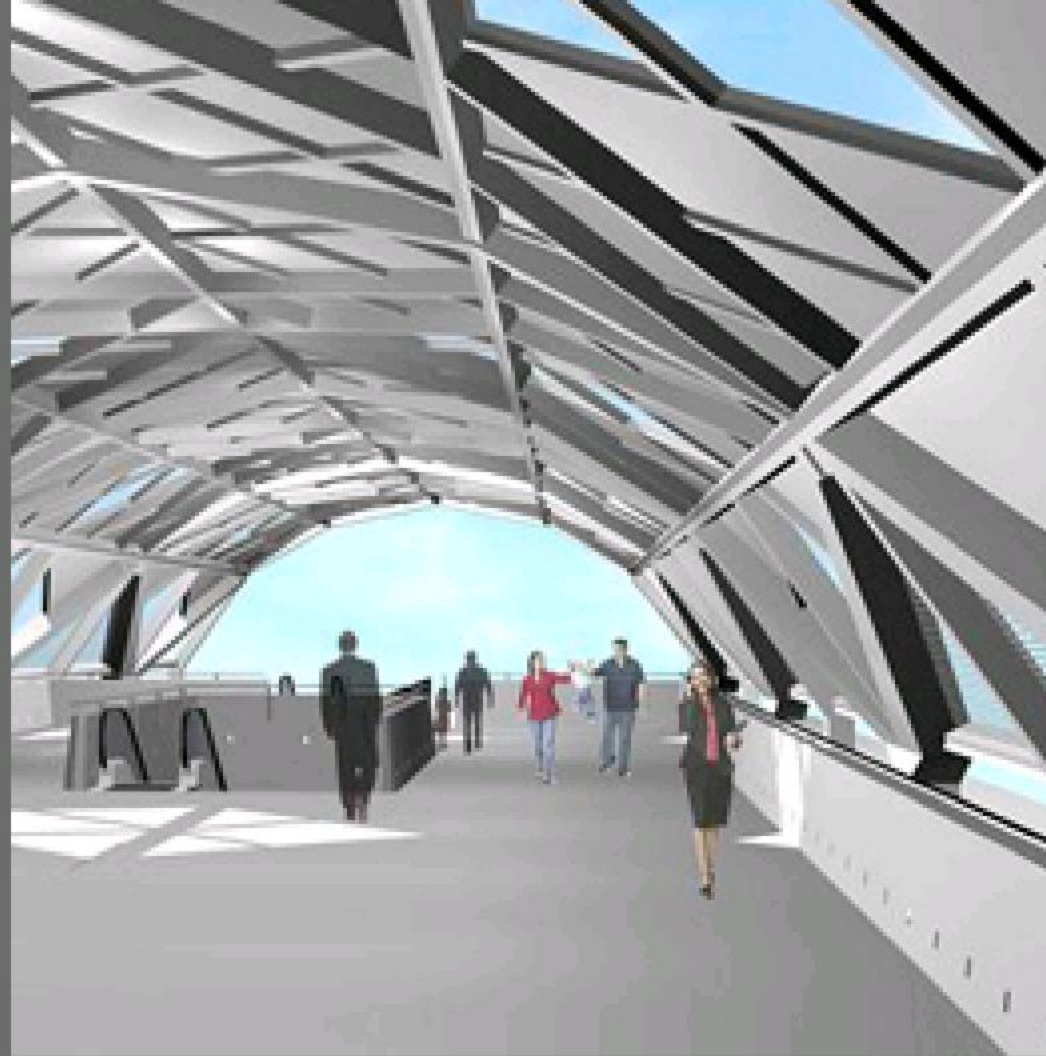

Washington Metropolitan Area Transit Authority
Art in Transit Program
In collaboration with
Virginia Department of Rail and Public Transportation

CALL TO ARTISTS

Deadline: June 30, 2006

Dulles Corridor Metrorail Project - Phase I Five Future Metrorail Stations in Virginia

The Washington Metropolitan Area Transit Authority (WMATA) Art in Transit Program commissions site-specific permanent artwork for the Metrorail system. The Art in Transit Program incorporates artwork into Metro transit facilities to promote transit use, enhance travel and highlight the cultural vitality of Metropolitan Washington, D.C. and the Nation.



Application Procedures

Interested artists must submit the following materials:

- A slide sheet containing a portfolio of 10 slides (loose slides will not be accepted or returned) or 10 high-resolution (a minimum of 300 dpi) jpeg images on a compact disk
- A resume and/or artist biography
- A self-addressed stamped envelope, if materials are to be returned

Only one submission is needed to be considered for all five stations. Do not send duplicate submissions. Submit materials to:

Michael Mc Bride
Manager
Environmental Graphic Design & Public Art
Department of Architecture Suite 4F-13
Washington Metropolitan Area Transit Authority
600 Fifth Street, NW
Washington, DC 20001

For more information about the Dulles Corridor Metrorail Project, please visit www.dullesmetro.com. For information about the WMATA Art in Transit Program, please visit www.metroopensdoors.com

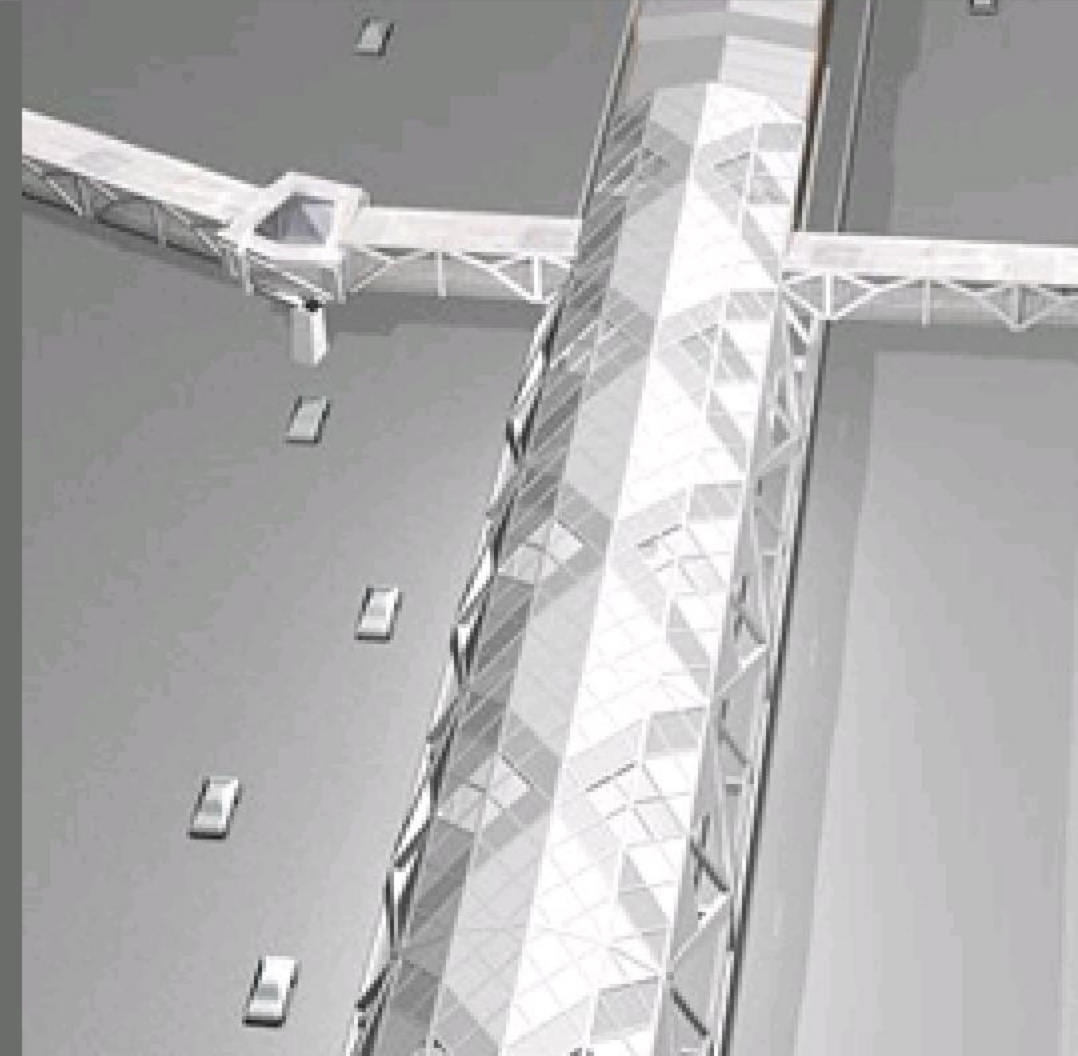



Design concepts by di Domenico + Partners, LLP. The renderings contained in this Call to Artists are for illustration purposes only. The final design concepts may be modified by the architect.

Selecting Artists and Awarding Commissions

An artist selection panel, including art and design professionals and community representatives, will choose three finalists for each station based on the quality of the artists' portfolio. Finalists will be given a detailed overview of their assigned station and receive a \$1,500 honorarium to create a site-specific artwork proposal. The three finalists for each station will present a station-specific proposal to the selection panel. The panel will review the proposals and recommend one proposal for each station. WMATA Art in Transit will present one panel-recommended proposal for each station to the Virginia Department of Rail and Public Transportation, the Metropolitan Washington Airports Authority, local and state public art review agencies for comments, and finally to the WMATA Board of Directors for approval. Approvals by the WMATA Board will result in the project commissioning five artists to work with the design-build team to further develop, fabricate and install the Board-approved artwork.



Project Description

WMATA Art in Transit in collaboration with the Virginia Department of Rail and Public Transportation is seeking artists with previous public art experience to develop site-specific artwork proposals for Phase 1 of the Dulles Corridor Metrorail Project. The Dulles Corridor Metrorail Project is a 23-mile extension of the existing 106-mile Metrorail system serving Washington, D.C. and adjacent suburbs in Maryland and Virginia. The first phase of the project includes five stations; four in Tysons Corner and one on the eastern edge of Reston. The alignment follows the exiting Dulles Toll Road and parts of Routes 123 and 7. The extension branches off the existing Orange Line between the East Falls Church Metro Station and the West Falls Metro Station and heads westward through Tysons Corner and on to Wiehle Avenue. The second phase of the project runs through Reston, Herndon, Washington Dulles International Airport and into Loudoun County. During Phase 1, the project will commission five artists to collaborate with the design-build team to integrate artwork into the overall designs of the five stations. The project will commission one artist to create artwork for each station. The artwork must reflect the artistic, cultural and/or historical interests of communities surrounding the stations.

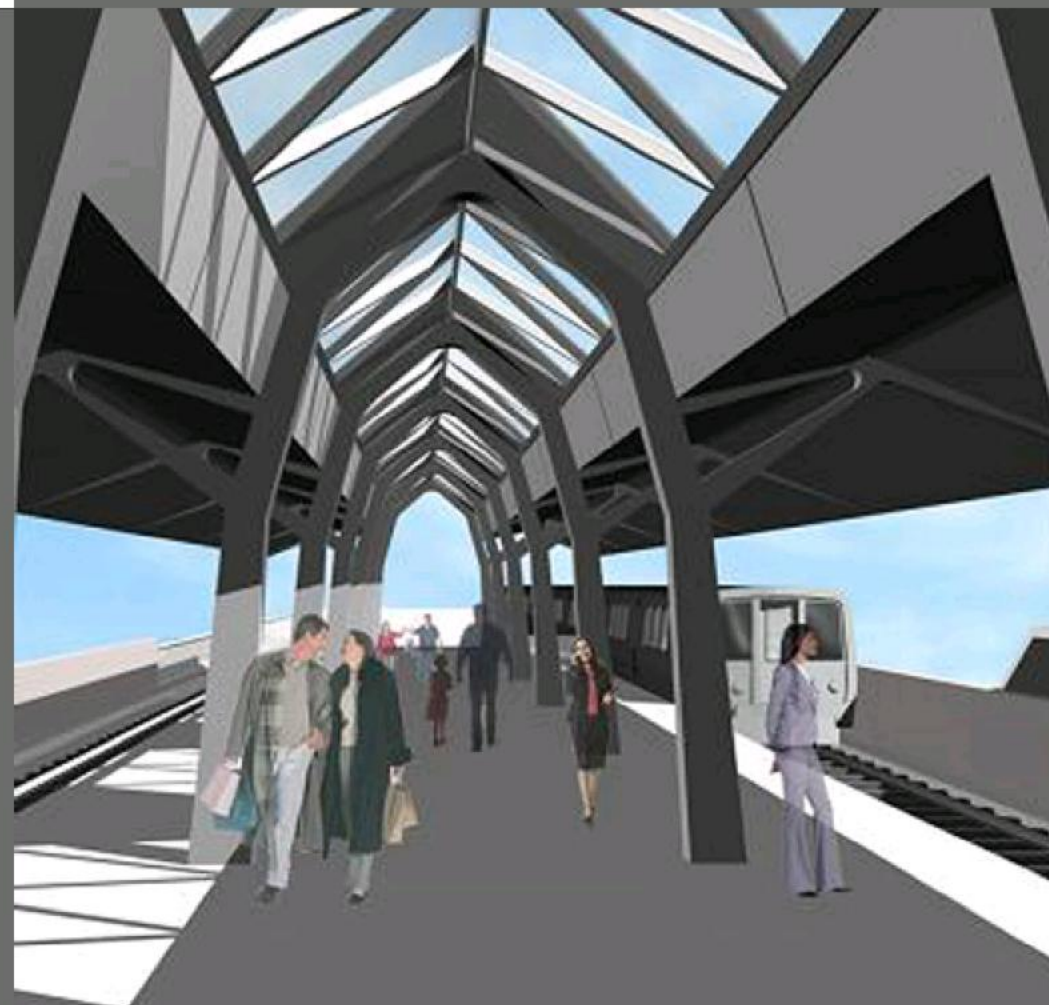

Project Budget

The maximum budget for the art project for each station is \$250,000 (artist fee included). The artist fee must not exceed 20% of the proposed artwork budget for each station. The artist will work with the design-build team to develop a budget for design development, fabrication and installation of the artwork. Finalists must thoroughly consider all potential costs prior to submitting a proposal. The final budget must include all costs for design, fabrication, project documentation, installation and handling artwork. The budget for art projects outlined in this Call To Artists is subject to the availability of funds.

Artist Eligibility

This Call to Artists is open to all artists with experience in the design and development of site-specific public art projects. Qualified artists will be considered regardless of race, color, creed, national origin, sex or age.